

## Setup Instructions 9611 Series Single Pedals

- A) Remove and recycle cardboard and plastic cover from pedal board and slide pedal frame into the *Quick Release Rock Plate*. Figs. 1 & 2.
- B) Adjust beater angle by loosening the key screw on the *Spring Rocker Hub* (GP-6002).
- C) Adjust pedal board height by loosening the key screw on the drive cam and rotate to desired angle. Fig. 3. A memory position lock on the axel provides two factory recommended pedal board height positions (not applicable for strap drive model).
- D) Adjust spring tension for desired response by loosening both upper and lower finger nuts to increase or decrease tension, then re-tighten.
- E) Adjust beater height by loosening the *Beater Shaft Memory Lock* (GP-6001) and reposition the beater. Fig. 3.
- F) To avoid pedal slippage, extend spurs on the frame and place on carpet.
- G) Loosen the fine adjustment screw on the hoop clamp, then slide pedal onto the bass drum hoop. Tighten the fine adjustment screw to fit snug on the hoop. Fig. 4.
- H) Lubricate metal-to-metal contact points periodically to insure smooth operation. Use SC-GLO Gibraltar Pedal Lubricant.
- I) Since some settling may occur during shipping, please check pedal board alignment to the frame and drive mechanism. Push the pedal board slightly left or right to align if needed.
- J) Remove the beater when placing the pedal in its included carrying bag.

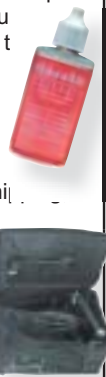

# 9611 Series Single Bass Drum Pedals

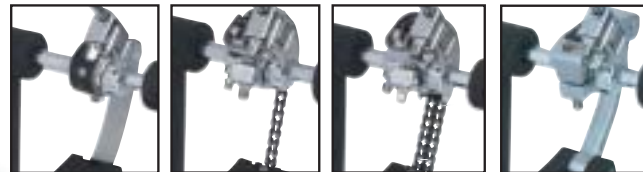

Strap Drive    Single Chain Drive    Double Chain Drive    Direct Drive

Check out the entire line of professional Gibraltar percussion gear at...

[www.GibraltarHardware.com](http://www.GibraltarHardware.com)

KAMAN MUSIC CORP.

## Replacement Part Numbers

- 1 - SC-DSAB The Gibraltar Dual-Surface Adjusting Beater will self-align the beater surface to a 90-degree angle with the bass drum head while playing. Choose the felt beater surface or rotate to the flat surface for more volume and attack. Use of a Gibraltar Impact Pad to reduce bass drum head wear.
- 2 - GP-6000 Beater Holder
- 3 - GP-6001 Beater Shaft Memory Lock
- 4a - GP-5068 Chain Cam
- 4b - GP-6009 Single Chain Cam
- 4c - GP-6005 Direct Drive Mechanism
- 4d - GP-6011 Strap Cam Assembly
- 5a - GP-4007 Dual Chain Assembly
- 5b - GP-6010 Single Chain Assembly
- 5c - SC-15B Replacement Strap
- 6 - GP-6002 Spring Rocker Hub
- 7 - GP-5096 Spring Assembly
- 8 - GP-5103 Spring Tension Assembly
- 9 - GP-5242 Rock Plate Screw Kit
- 10 - GP-5074 Hoop Clamp Assembly
- 11 - SC-2000 Pedal Board Hinge
- 12 - GRP2 Quick Release Rock Plate

\* Note - Some replacement parts may not be available for sale but for warranty replacement only. Please see your dealer for availability.

### Tools Included:

\* Angled Drum Key

\* Allen Wrench Set (2)  
for use on all recessed screws  
Tighten all screws periodically

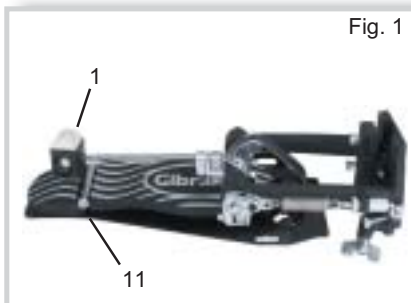

Folds Flat



Quick Release Rock Plate



Drive Shaft Components

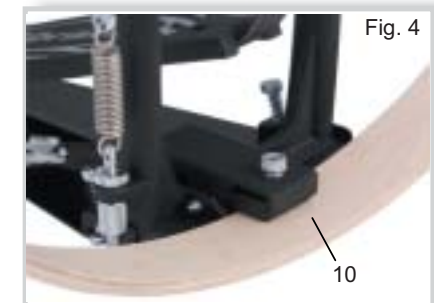

Super Grab Hoop Clamp